



**Fosters**  
sales & lettings



7 Tarragon Drive, Guildford, Surrey, GU2 9GP

£2,200 Per Calendar Month



- 2 Bedroom
- Gas Central Heating/Solar panels
- Off Road Parking
- Available Mid August
- Council Tax Band D
- Large Rear Enclosed Garden With Patio
- Large Kitchen/Dining Room
- Garage
- 5 Weeks' Deposit £2538.46
- EPC Energy Rating Band (b) 88

## THE PROPERTY

A substantial 2 double bedroom semi detached home, offering well balanced accommodation the property offers a front aspect lounge with a full width kitchen diner overlooking the south facing garden. To the first floor there are 2 generous bedrooms, and a 4 piece family bathroom.

Other benefits include the solar panels which we are advised supply most of the energy used within the home, off road parking for 2 cars, garage with workshop behind, home office within the garden and gas central heating.

The house is positioned well for local amenities and access to bus routes, the A3, Guildford and much more!

Available

## SITUATION

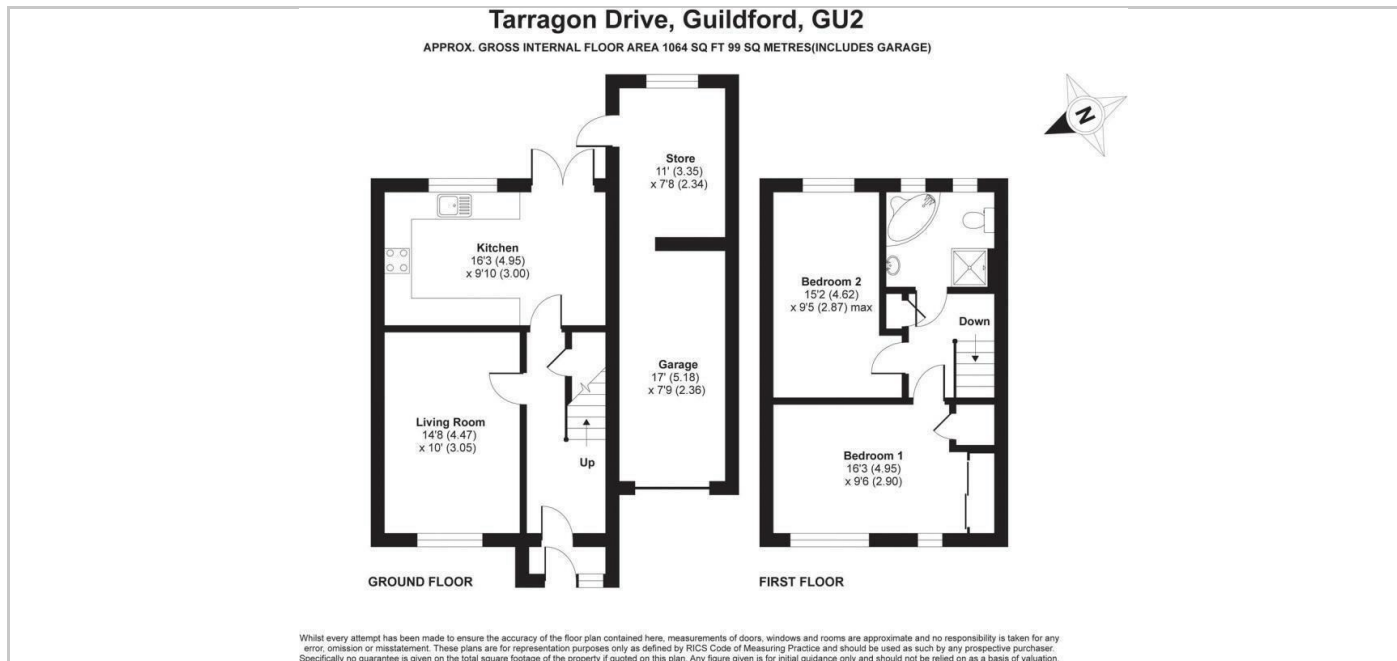

## Directions